

SHARP®

FP-FM40A



High-Density 7000*

"Plasmacluster" and "Device of a cluster of grapes" are trademarks of Sharp Corporation.

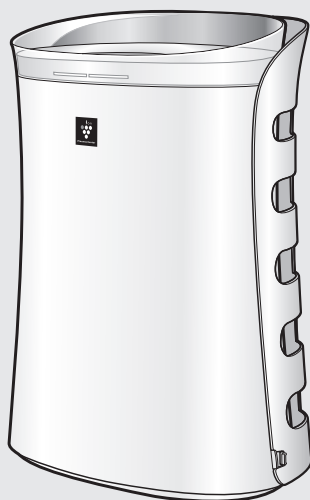

*The number in this technology mark indicates an approximate number of ions supplied into air of 1 cm³, which is measured around the center of a room with the "high-density plasmacluster 7000" applicable floor area (at 1.2 m height above the floor) at the medium wind volume in air purifying mode, when an air purifier using the high-density plasmacluster ion evolving device is placed close to a wall. This product is equipped with a device corresponding to this capacity.

Free standing type

直立型

**AIR PURIFIER
WITH MOSQUITO CATCHER
OPERATION MANUAL**

捕蚊空氣清新機
使用說明書

ENGLISH

中文

Please read before operating your new Air Purifier

The air purifier draws in room air from the air intake, passes the air through a Pre-Filter, an Active Carbon Deodorizing Filter and a HEPA Filter inside of the unit, then discharges the air through the air outlet. The HEPA Filter can remove 99.97% of dust particles as small as 0.3 microns that pass through the filter.

The Active Carbon Deodorizing Filter gradually absorbs odors as they pass through the filter.

Some odors absorbed by the filters may break down over time, resulting in additional odor. Depending on the usage environment, especially when the product is used in extreme environments (significantly more severe than normal household use), this odor may become strong in a shorter period than expected. If the odor persists, the filters should be replaced.

Mosquito Catcher Function

Mosquitoes are attracted by UV light, black color body and easy-hiding sized window of Catch Panel. When the mosquitoes come to the trap window of Catch Panel closely, they are sucked by the powerful airflow, then they are firmly caught by powerful Glue Sheet attached to the inner side of Catch Panel.

NOTE

- The air purifier is designed to remove air-suspended dust and odor, but not harmful gases (for example, carbon monoxide contained in cigarette smoke). If the source of the odor still exists, the air purifier may not completely remove the odor.
- Mosquito Catcher mode may not catch all the mosquitoes in the room.
- The mosquitoes which have not got caught in Glue Sheet might escape from the window of Catch Panel, so please do not switch off the power while Mosquito Catcher is in operation as much as possible except for exchanging filters and Glue Sheet.

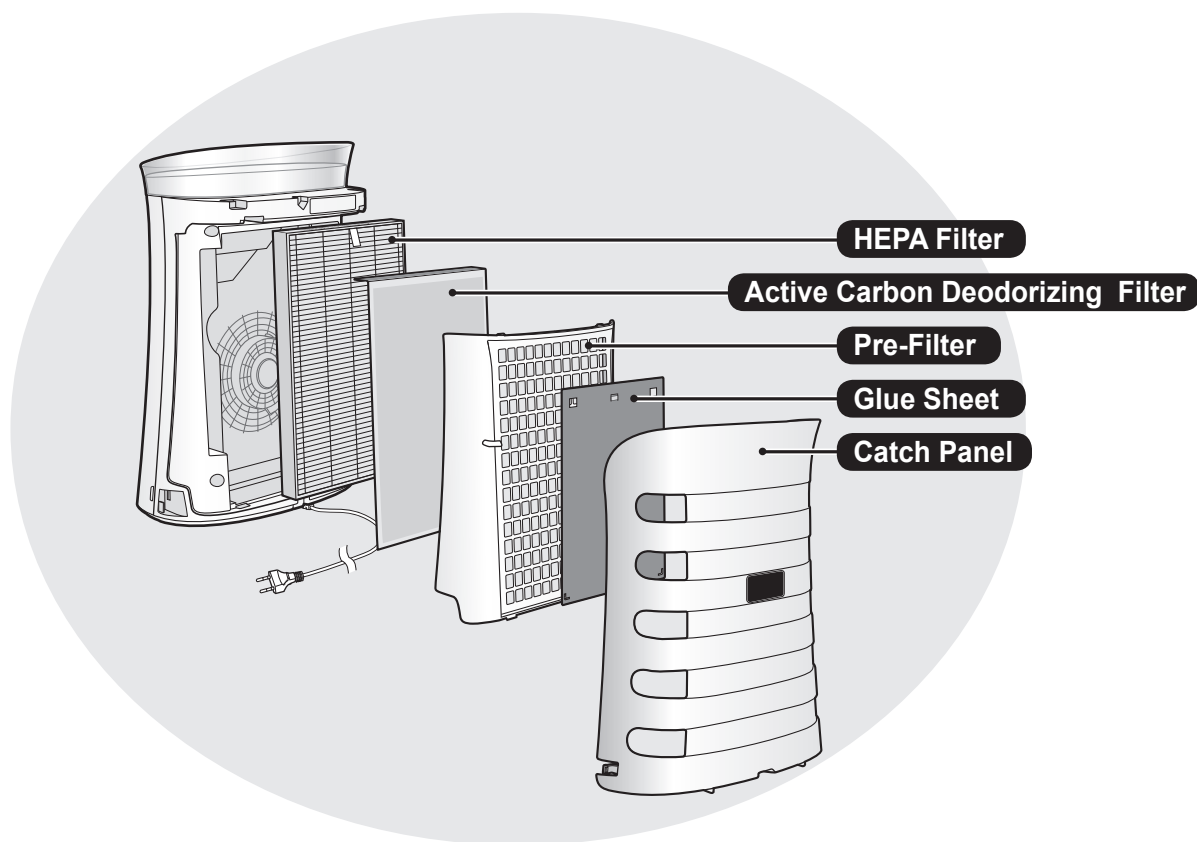

FEATURES

Unique Combination of Air treatment Technologies Plasmacluster + Triple Filtration System + Mosquito Catcher Function

(1) High Density Plasmacluster 7000
Plasmacluster treats the air similar to the way nature cleans the environment by emitting a balance of positive and negative ions.

(2) Filtration System

Traps Dust*
Pre-filter traps dust and other large airborne particles.

Decreases Odors
Active Carbon Deodorizing Filter absorbs many common household odors.

Reduces Pollen & Mold*
HEPA filter traps 99.97% of particles as small as 0.3 microns.

*When air is drawn through the filter system.

(3) Harmless Mosquito Catcher Function
Attracts mosquito by UV light, black body, size of entrance, powerful airflow and suction, and catches the mosquito by powerful glue sheet.

CONTENTS

IMPORTANT SAFETY INSTRUCTIONS	E-2
PART NAMES	E-4
FILTER AND GLUE SHEET INSTALLATION.....	E-6
OPERATION	E-8
USEFUL FUNCTIONS	E-10
CARE AND MAINTENANCE	E-12
REPLACEMENT GUIDELINES	E-14
TROUBLESHOOTING	E-16
SPECIFICATIONS.....	E-17

Thank you for purchasing the SHARP Air Purifier. Please read this manual carefully. Before using this product, be sure to read the section: "Important Safety Instructions." After reading this manual, keep it in a convenient location for future reference. For your reference, we recommend to keep this manual in the place where you can read at any time.

IMPORTANT SAFETY INSTRUCTIONS

When using electrical appliances, basic safety precautions should be followed, including the following:

WARNING - To reduce the risk of electrical shock, fire or injury to persons:

- Read all instructions before using the unit.
- Use only a 220 volt outlet.
- **Do not use the unit if the power cord or plug is damaged or the connection to the wall outlet is loosened.**
- Periodically remove dust from the power plug.
- **Do not insert fingers or foreign objects into the air intake or air outlet.**
- **When removing the power plug, always hold the plug and never pull the cord.** Electrical shock and/or fire from short circuit may occur as a result.
- Be careful not to damage the power cord, it may cause electric shock, excess heat or fires.
- **Do not remove the plug when your hands are wet.**
- **Do not use this unit near gas appliances or fireplaces.**
- **Remove the power plug from the wall outlet before cleaning the unit and when not using the unit.** Electrical shock from bad insulation and/or fire from short circuit may occur as a result.
- **When cleaning the unit, or when the unit is not in use, be sure to unplug the unit. Electrical shock and/or fire from a short circuit may result.**
- **If the power cord is damaged, it must be replaced by the manufacturer, its service agent, Sharp Authorized Service Centre or similarly qualified person in order to avoid a hazard.**
- Do not operate when using aerosol insecticides or in rooms where there is oily residue, incense, sparks from lit cigarettes, chemical fumes in the air or in very high humidity conditions, such as a bathroom.
- Be cautious when cleaning the unit. Corrosive cleansers may damage the exterior.
- Only a Sharp Authorized Service Centre should service this air purifier. Contact the nearest Service Centre for any problems, adjustments, or repairs.
- This appliance is not intended for use by persons (including children) with reduced physical, sensory or mental capabilities or lack of experience and knowledge unless they have been given supervision or instruction concerning use of the appliance by a person responsible for their safety. Children shall not play with the appliance. Cleaning and user maintenance shall not be made by children without supervision.

NOTE - Radio or TV Interference

If this air purifier should cause interference to radio or television reception, try to correct the interference by one or more of the following measures:

- Reorient or relocate the receiving antenna.
- Increase the separation between the unit and radio/TV/wave-clock receiver.
- Connect the equipment into an outlet on a circuit different from that to which the receiver is connected.
- Consult the dealer or an experienced radio/TV technician for help.

CAUTIONS CONCERNING OPERATION

- Do not block the air intake and/or air outlet.
- Do not use the unit near or on hot objects, such as stoves or heaters or where it may come into contact with steam.
- Do not lay the unit down when using.
- **Always hold the handle at the back of the unit when moving it.**
- Do not use the unit without the filters inside.
- **Do not wash and reuse the HEPA filter and the Active Carbon Deodorizing Filter.**
Not only does it not improve filter performance, it may cause electric shock or malfunction.
- Do not look directly into the UV light. The UV light meets the standards of IEC 62471.

CAUTIONS CONCERNING GLUE SHEET

- Handle the Glue Sheet with care. Avoid children or pet from touching the sticky surface.
- If the glue adheres to hands or clothing, rub with cooking oil, wash well with soap and water.
- Dust and dirt collected on the sheet may reduce the effectiveness of Glue Sheet.
- If no mosquitoes are collected on the sheet, try changing the location of the unit.
- Dispose it according to the local disposal laws and regulations.
- This is a safe adhesive type product. No toxic ingredients are used.

INSTALLATION GUIDELINES

- When using the unit, place it away from equipment utilizing electric waves such as televisions or radios to avoid electrical interference.
- **Avoid using in locations where furniture, fabrics or other items may come in contact with and restrict the air intake and/or air outlet.**
- **Avoid using in locations where the unit is exposed to condensation or drastic temperature changes. Appropriate condition is at room temperature 0 – 35 °C.**
- **Place on a stable surface with sufficient air circulation.**
When placing the unit on a heavily carpeted area, the unit may vibrate slightly.
- **Avoid locations where grease or oily smoke is generated.**
The unit surface may crack as a result.
- **The dust collecting ability of the unit is effective even when the unit is close to the wall, the surrounding walls and floor may get dirty. Please place the unit at a distance from the wall. The wall directly behind the air outlet may become dirty over time. When using the unit for an extended period of time at the same location, periodically clean the walls adjacent to it.**

FILTER GUIDELINES

- Follow the instructions in this manual for correct care and maintenance of the filters.

PART NAMES

FRONT

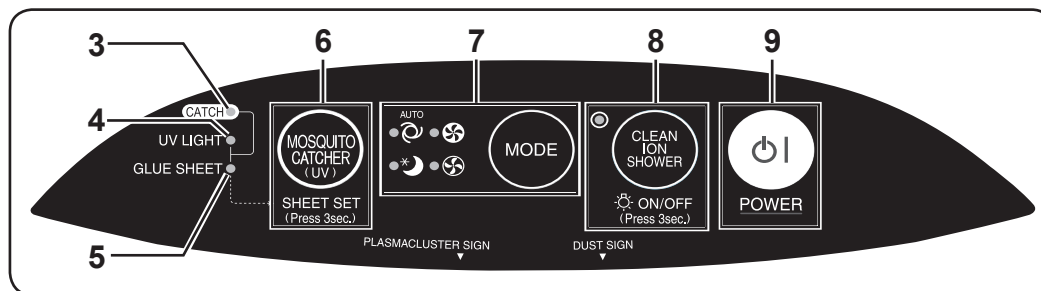

PLASMACLUSTER SIGN
 Blue.... Plasmacluster ON
 Off.... Plasmacluster OFF

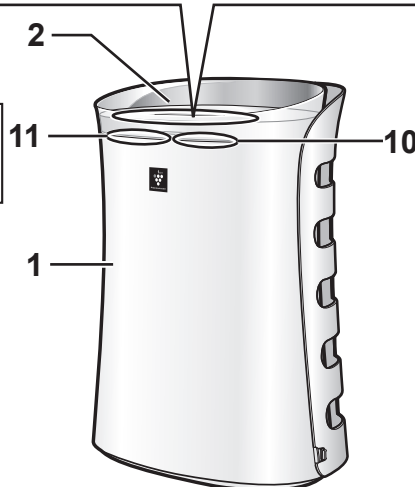

DUST SIGN
 Indicates the air purity of the room
 in 3 levels with color changes.

Green [light gray bar] Clean
 Orange [medium gray bar]
 Red [dark gray bar] Dirty

1	Main Unit	7	MODE Button / MODE Indicator Light (green) / Plasmacluster Ion ON/OFF Button (Press 3sec.)
2	Air Outlet	8	CLEAN ION SHOWER Button / CLEAN ION SHOWER Indicator Light (green) / Light ON/OFF Button (Press 3sec.)
3	CATCH Lamp (blue)	9	POWER ON/OFF Button
4	UV LIGHT Lamp (blue)	10	DUST SIGN
5	GLUE SHEET Lamp (blue)	11	PLASMACLUSTER SIGN
6	MOSQUITO CATCHER Button / SHEET SET Button (Press 3sec.)		

BACK

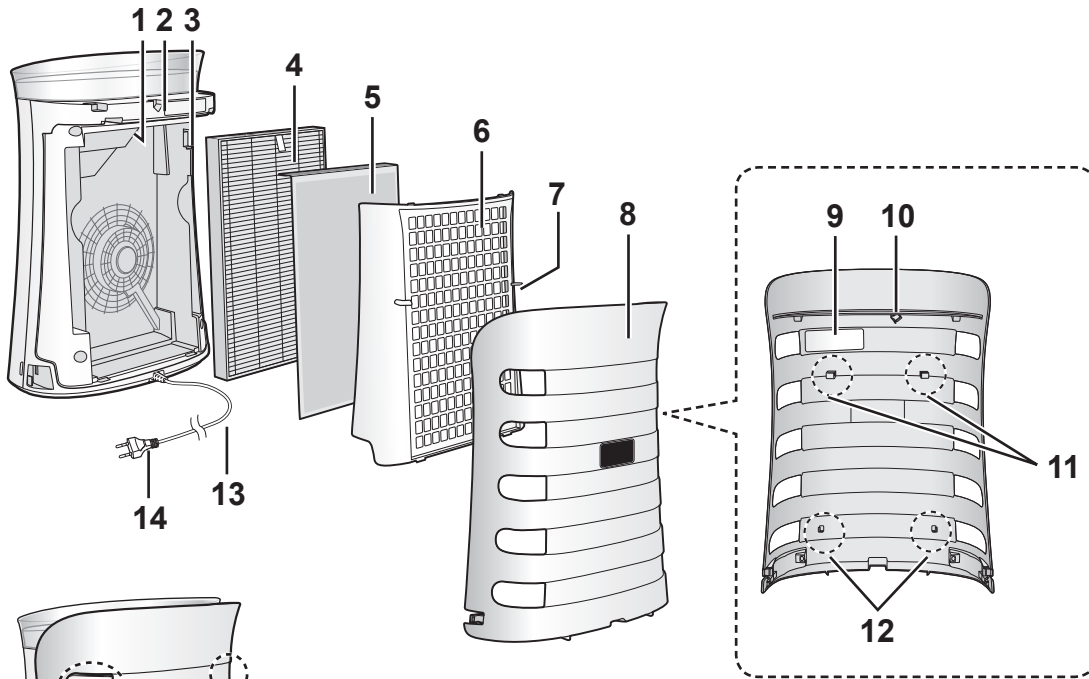

INCLUDED

- Glue Sheet : 1unit

- Glue Sheet Operation Manual
- Glue Sheet Date Label

X 2 SETS

1	UV Light	9	Date Label
2	Magnet Sensor	10	Magnet
3	Dust sensor / Dust sensor Filter	11	Upper Hooks
4	HEPA Filter	12	Bottom Hooks
5	Active Carbon Deodorizing Filter	13	Power Cord
6	Pre-Filter	14	Plug (Shape of plug depends on country.)
7	Pre-Filter Tabs	15	Handles
8	Catch panel	16	Glue Sheet (3 sheets laminated)
		17	Mosquito Tray

FILTER AND GLUE SHEET INSTALLATION

To maintain the quality of the filter and Glue Sheet, it is installed in the main unit and packed in plastic bag. Be sure to remove the filter and Glue Sheet from the plastic bag before using the unit.

- 1** Remove the Catch Panel from underpart.

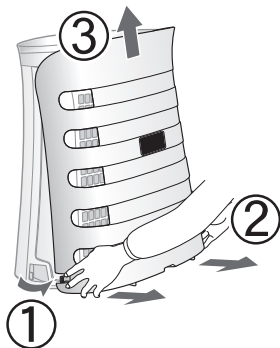

- 2** Hold the tabs of Pre-filter, lift it and remove it from its underpart.

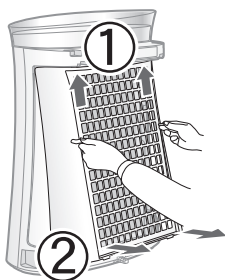

- 3** Remove the plastic bag and take out the Filter.

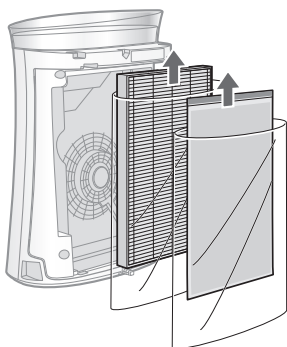

- 4** Hold upper part of Active Carbon Deodorizing Filter, covering the upper part of HEPA Filter, and set it.

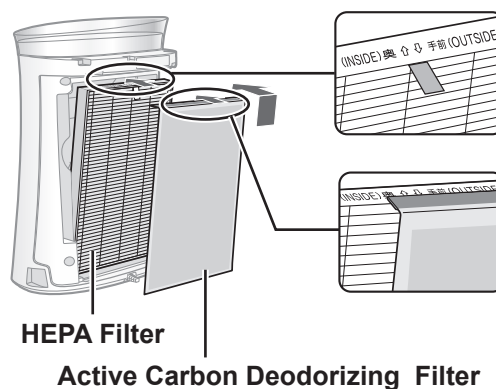

- 5** Hold the tabs of Pre-Filter, and replace it from upper part.

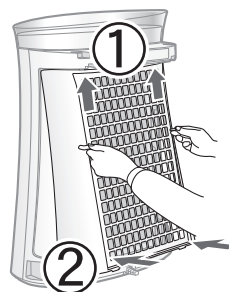

- 6** Fill in the usage start date on the Date Label. Use the date as a guide for the filter replacement schedule.

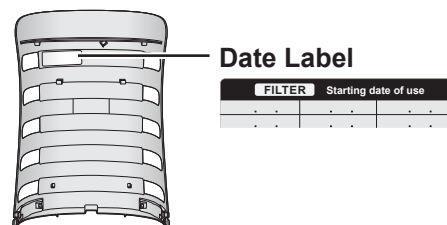



Be sure to remove the power plug from the wall outlet.

- 7** Remove the plastic bag and take out the Glue Sheet.
- Keep the additional Glue Sheet away from direct sunlight and lay it flat with glue side face up.

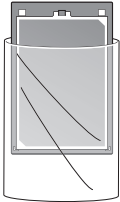

- 8** Fill in the usage start date on the Glue Sheet Date Label. Use the date as a guide for the Glue Sheet replacement schedule.

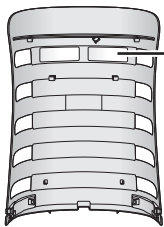

Glue Sheet Date Label



- 9** Prepare the Mosquito Tray. Lock it to the Bottom Hooks.

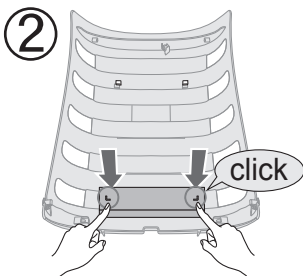
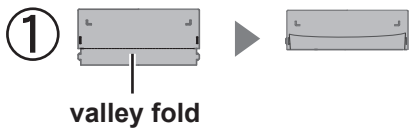

- 10** Hang the Glue Sheet on Upper Hooks and then insert into Bottom Hooks.

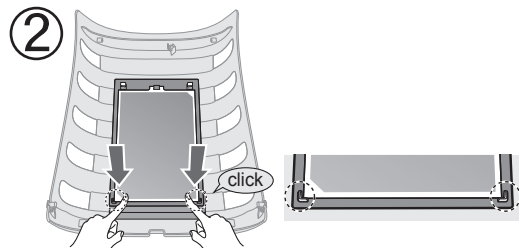
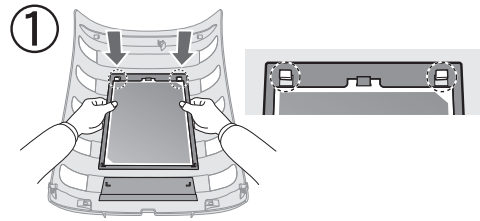

- 11** Remove the protective film slowly from the corner of Glue Sheet.
- Dispose protective film as burnable rubbish.
 - Make sure that its bottom part is properly inserted to the Bottom Hooks.

Be careful that Glue Sheet doesn't stick to hairs and clothes.



- 12** Replace Catch Panel from upper part.

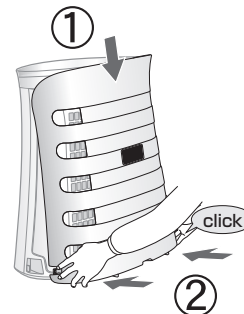

ENGLISH

OPERATION

CLEAN AIR

START



STOP



- Select the desired fan speed.
- Unless the power cord has been unplugged, the operation starts in the previous mode it was operated in.

CLEAN ION SHOWER

Releases high-density Plasmacluster ions and discharges strong air flow for 60 minutes.

START



NOTE

- CLEAN ION SHOWER mode is available while using mosquito catcher mode.
- If Plasmacluster Ion is OFF, Plasmacluster Ion will not be released.
- When the operation finishes, the unit will return to the prior operation mode.
It is able to change the other mode and  during this mode.

FAN SPEED

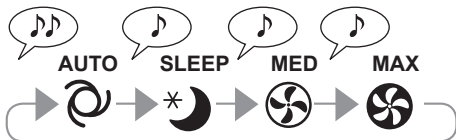
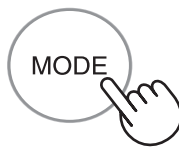

NOTE

AUTO

- The fan speed is automatically switched depending on the amount of impurities in the air. The sensors detect impurities for efficient air purification.

SLEEP *

- The unit will operate very quietly, and the fan speed is automatically switched depending on the amount of impurities in the air.
It will darken the brightness of the following lamp.
CATCH Lamp / UV Light Lamp / GLUE SHEET Lamp / UV Light of the backside.
DUST/PLASMACLUSTER SIGN go off automatically.
Even though the indicator is off, Plasmacluster Ion is released into air unless Plasmacluster Ion is turned off by pressing  for 3sec.

MOSQUITO CATCHER

Use this function to catch mosquitoes.

Mosquito catching function(CATCH lamp) will turn on when both UV LIGHT and GLUE SHEET work properly.

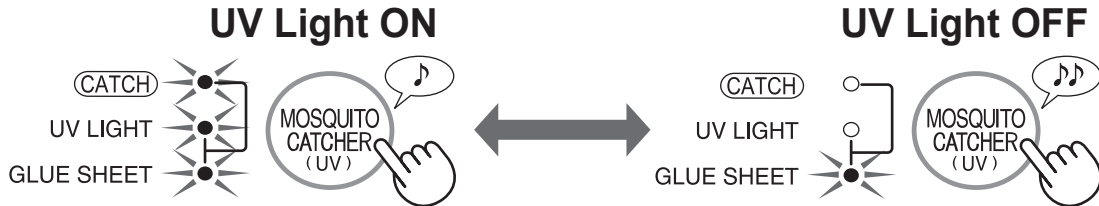

NOTE

Select Max mode to catch mosquitoes more effectively.

The higher the air volume is, the easier to capture mosquitoes becomes.

CATCH lamp

When UV LIGHT lamp is on and GLUE SHEET lamp is on, CATCH lamp is on.

When UV LIGHT lamp is off or GLUE SHEET lamp is flashing, CATCH lamp is off.

UV LIGHT lamp

When Mosquito Catcher button is pressed, UV LIGHT lamp is turned on and conversely.

UV LIGHT  When Catch Panel comes off, UV light is turned off automatically by Magnet sensor. Check whether catch panel is properly attached.

UV LIGHT  When UV LIGHT lamp is flashing, UV Light has failed. Contact the service center authorized by Sharp.

GLUE SHEET lamp

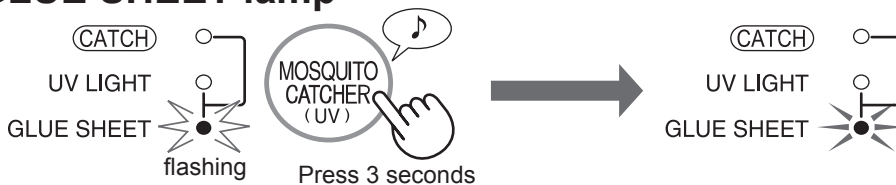

- Flashing Glue Sheet lamp indicates time to change Glue Sheet.
 - Glue Sheet comes in 3 layers with each layer laminated. Change the Glue Sheet by peeling off the used one. When all layers have been used, replace with a new sheet.
 - Press the Mosquito Catcher button for 3 seconds.
 - Glue Sheet lamp changes from flashing to lighting.
- Glue Sheet lamp flashes approx. 1 month(24 hours x 30 days) after you press Mosquito Catcher button for 3 seconds.
- At the first time of using the product, after inserting a plug in a socket and turning on the power, Glue Sheet lamp will be flashing by default. Install Glue Sheet to catch panel (see page E-7), then press the Mosquito Catcher button for 3 seconds.
- We recommend you to keep this product working as much as possible to maximize its function except for exchanging filter and Glue sheet.

USEFUL FUNCTIONS

Light Control

You can set the DUST/PLASMACLUSTER SIGN to OFF when they are lighting up.

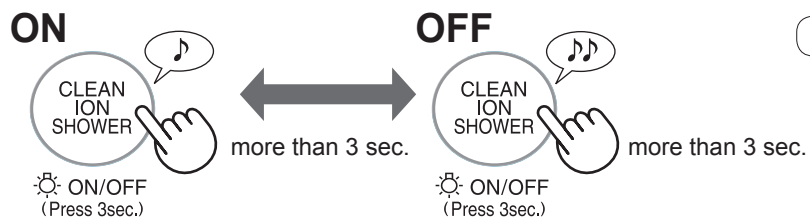

NOTE

- When the unit starts operation, the DUST/PLASMACLUSTER SIGN always lights.
- In SLEEP mode, Light Control button doesn't operate.

Plasmacluster Ion ON/OFF

When Plasmacluster Ion is ON, the PLASMACLUSTER SIGN will turn on. (blue)
(In operation)

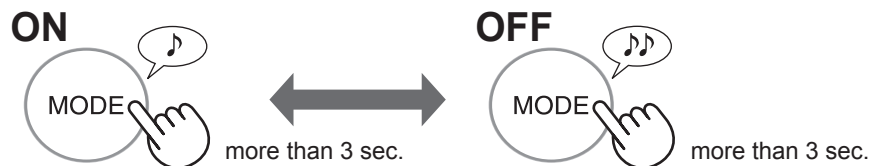

ADJUSTMENT OF SENSOR DETECTION SENSITIVITY

Set to "Low" if the DUST SIGN is constantly red to reduce sensitivity, and set to "High" if the DUST SIGN is constantly green to increase sensitivity.

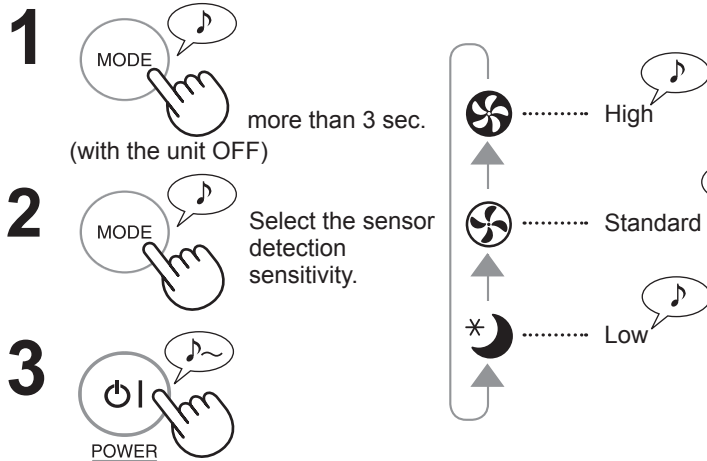

NOTE

- If the power OFF Button is not pressed within 8 seconds of adjusting sensor sensitivity, the setting will be saved automatically.
- The sensor sensitivity setting will be saved even if the unit is unplugged.

AUTO RESTART

If the unit is unplugged or there is a power failure, the unit will resume operation with the previous settings after power is restored.

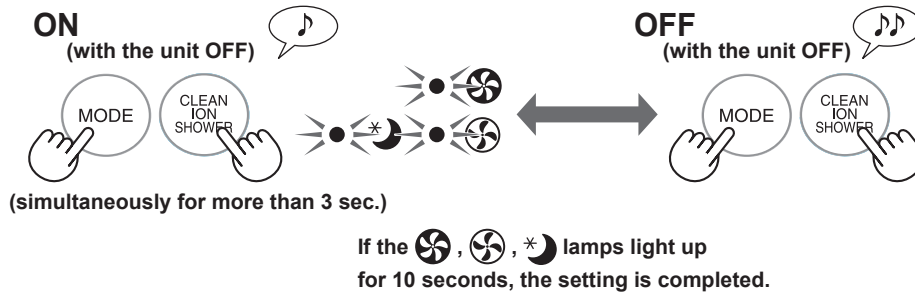

CARE AND MAINTENANCE



To maintain optimum performance of this air purifier, please clean the unit including the filter periodically.

Be sure to disconnect the power cord from the wall outlet before performing any maintenance.

UNIT



Wipe with a dry, soft cloth

For stubborn stains or dirt, use a soft cloth **dampened with warm water.**

CAUTION

•Do not use volatile fluids

Benzene, paint thinner, polishing powder, etc. , may damage the surface.

•Do not use detergents

Detergent ingredients may damage the unit.

Pre-filter

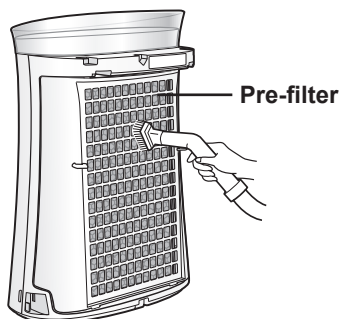

Gently remove dust from the Pre-filter, using a vacuum cleaner attachment or similar tool.

CAUTION

Do not apply excessive pressure, when scrubbing the pre-filter

NOTE

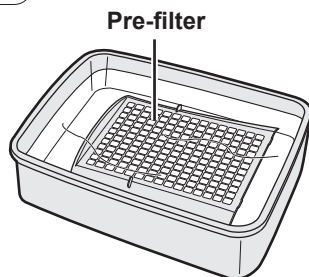
 How to clean stubborn dirt

1. Add a small amount of kitchen detergent to water and soak for about 10 minutes.
2. Rinse off the kitchen detergent with clean water.
3. Completely dry the filter in a well-ventilated area.

SENSOR

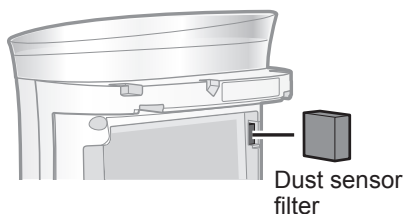

1. Remove the Catch Panel.
2. Remove the Pre-filter.
3. Remove the Dust sensor filter.
4. If it is very dirty, wash it with water and dry it thoroughly.

Be sure to remove the power plug from the wall outlet.

FILTERS

HEPA Filter

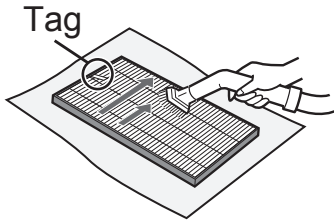

Gently remove dust from HEPA FILTER with a vacuum cleaner attachment or similar tool.

CAUTION

- Do not WASH in water and DRY in the sun.
 - Apply the maintenance only on the side with the tag. Do not clean the opposite side; otherwise, the filter will be damaged.
- The filter is fragile, be careful not to apply too much force.

Active Carbon Deodorizing Filter

Pat the filter gently.

CAUTION

- The filter is fragile, be careful not to apply too much force.

CATCH PANEL

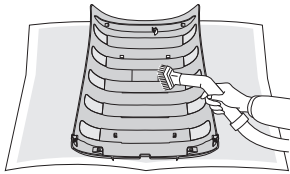

Remove the Glue Sheet and Mosquito Tray, and then gently remove dust from the Catch Panel by using a vacuum cleaner attachment or similar tool.

CAUTION

Do not apply excessive pressure, when scrubbing the catch panel.

GLUE SHEET

When Glue Sheet lamp indicator light is flashing

①

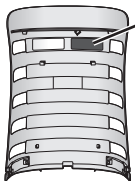

Glue Sheet Date Label

Fill in the usage start date on the Glue Sheet Date Label. Use the date as a guide for the Glue Sheet replacement schedule.

②

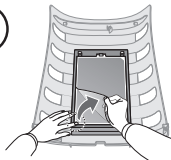

Peel off the used Glue Sheet slowly from the corner of the sheet. The Glue Sheet comes in 3 layers.

NOTE

- When all layers have been used, replace with a new Glue Sheet. (E-15)
- Be careful so that Glue Sheet doesn't stick to hairs and clothes.

After setting Glue Sheet



REPLACEMENT GUIDELINES



FILTER REPLACEMENT GUIDELINES

Replacement timing About 2 years after operating

Do not wash and reuse the filter

The filter life and replacement period are based on the condition of smoking 5 cigarettes per day and the dust collection power and deodorizing capacity are reduced by half compared with that of new filter.

Filter life varies depending on the room environment, usage, and location of the unit.

We recommend to replace the filters more frequently if the product is used in a condition significantly severer than normal household use.

REPLACING THE FILTER

Replacement Filter

Model:FZ-F40SFE

- HEPA Filter : 1 unit
- Active Carbon Deodorizing Filter: 1 unit

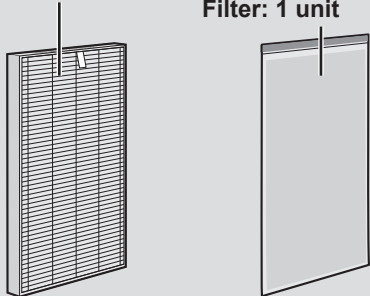

See page E-6 for directions on how to install the filter when replacing.

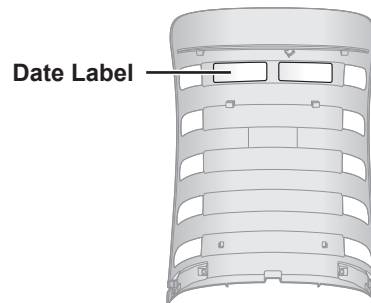

- Please consult your dealer for purchase of replacement filter.
- Use only filters designed for this product.

Disposal of Filters

Please dispose the replaced filters according to the local disposal laws and regulations.

HEPA Filter materials :

- Filter : Polypropylene
- Frame : Polyester

Active Carbon Deodorizing Filter materials :

- Polypropylene, Polyester, Activated charcoal

Be sure to remove the power plug from the wall outlet.

GLUE SHEET REPLACEMENT GUIDELINES

Replacement timing About 3 months after plugging into socket

ENGLISH

REPLACING THE GLUE SHEET

Replacement Glue Sheet

Model : FZ-40STSA

- Glue Sheet : 1unit



- Glue Sheet Operation Manual
- Glue Sheet Date Label
- Mosquito tray

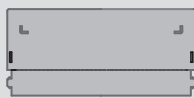

See page E-7 for directions on how to install the Glue Sheet when replacing.

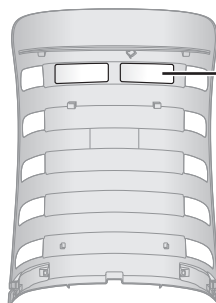

Glue Sheet Date Label

- Please consult your dealer for purchase of replacement Glue Sheet.
- Use only Glue Sheet designed for this product.

Disposal of Glue Sheet

Please dispose the replaced Glue Sheet according to the local disposal laws and regulations.

Glue Sheet materials :

- Glue: Polybutene
- Glue sheet: Paper
- Film: PET
- Base Sheet: PVC

Mosquito Tray material :

- PVC

TROUBLESHOOTING

Before calling for service, please review the Troubleshooting chart below, since the problem may not be a unit malfunction.

SYMPTOM	REMEDY (not a malfunction)
Odors and smoke are not removed.	<ul style="list-style-type: none"> Replace the filters if they appear to be heavily soiled. (E-14)
The DUST SIGN illuminates green even when the air is impure.	<ul style="list-style-type: none"> The air could be impure at the time the unit was plugged in. Unplug the unit, wait one minute, and plug the unit in again.
The DUST SIGN illuminates orange or red even when the air is clean.	<ul style="list-style-type: none"> Sensor operation is affected if the dust sensor filter is dirty or clogged. Gently clean the dust sensor filter. (E-12).
A clicking or ticking sound is heard from the unit.	<ul style="list-style-type: none"> Clicking or ticking sounds may be audible when the unit is generating ions.
The discharged air has an odor.	<ul style="list-style-type: none"> Check to see if the filters are heavily soiled. Clean or replace the filters. Plasmacluster Air Purifiers emit small traces of ozone which may produce an odor. These ozone emissions are well below safety level.
The unit does not operate properly when cigarette smoke is in the air.	<ul style="list-style-type: none"> Is the unit installed in a location that is difficult for the sensor to detect cigarette smoke? Is the dust sensor filter blocked or clogged? (In this case, clean the filter.) (E-12)
The DUST SIGN is turned off.	<ul style="list-style-type: none"> Check to see if the Lights OFF Mode selected. Press  for 3 seconds to light On. (E-10) Check to see if the SLEEP mode is selected. The DUST/PLASMACLUSTER SIGN are turned off automatically after the SLEEP mode is selected. (E-8)
The DUST SIGN lights change color frequently.	<ul style="list-style-type: none"> The DUST SIGN lights automatically change colors as impurities are detected by the dust sensor.
Catch lamp is turned off.	<p>Please check whether the following 2 lamps are on.</p> <ol style="list-style-type: none"> UV LIGHT lamp lights in blue. GLUE SHEET lamp lights in blue. <p>When UV LIGHT lamp is off or GLUE SHEET lamp is flashing, CATCH lamp does not turn on.</p>
UV LIGHT lamp is turned off.	<p>This lamp is the indicator of the UV Light at the back. If Catch Panel comes off or is not properly set, UV light is automatically turned off by Magnet Sensor. Please confirm whether catch panel is properly attached.</p>
UV LIGHT lamp is flashing.	<p>UV Light has failed. Please call the service center authorized by Sharp.</p>

SYMPTOM	REMEDY (not a malfunction)
GLUE SHEET Lamp is flashing	Peel off one layer or exchange a new Glue Sheet set when all layers have been used. Then, press the Mosquito Catcher button for 3 sec.
No mosquitoes are collected on the Glue Sheet.	<ul style="list-style-type: none"> • Try relocating the unit. • Peel off one layer or exchange a new Glue Sheet set.
When the adhesive glue remains on clothes, skin, floor, etc.	<ul style="list-style-type: none"> • Wipe with cooking oil, then wash with soap and water.
SLEEP lamp is flashing.	<ul style="list-style-type: none"> • Fan motor error. Turn the power OFF. Wait one minute, and then turn the power ON.

SPECIFICATIONS

Power supply		220 V 50 Hz		
Fan Speed Operation	Fan Speed	MAX	MED	SLEEP *1
	Rated Power (W)	33	14	3.7~6.2
	Airflow (m ³ /hour)	240	150	48~90
Recommended Room Size (m ²)		~30 *2		
High density Plasmacluster ion recommended room size (m ²)		~23 *3		
Cord Length (m)		2.0		
Dimensions (mm)		394(W)×281(D)×540(H)		
Weight (kg)		5.8		

*1 The fan speed is automatically switched depending on the amount of impurities in the air.

*2 Size of a room which is appropriate for operating the unit at maximum fan speed.

- It indicates the space where a certain amount of dust particles can be removed in 30 minutes (JEM1467).

*3 Size of a room in which approximately 7000 ions can be measured per cubic centimeter in the center of the room (at a height of approximately 1.2 meters from the floor) when the product is placed next to a wall and run at the MED operation position.

Standby Power

In order to operate the electrical circuits while the power plug is inserted in the wall outlet, this product consumes about 1.0W of standby power.
For energy saving, unplug the power cord when the unit is not in use.

SHARP

SHARP CORPORATION

OSAKA, JAPAN

Printed in Thailand
TINS-A957KKRZ 16F- (TH) ①