

This chapter describes how to replace the toner cartridge and how to clean the unit.



Note

Be sure to use only genuine SHARP parts and supplies.



For best copying results, be sure to use only SHARP Genuine Supplies which are designed, engineered, and tested to maximize the life and performance of SHARP copiers. Look for the Genuine Supplies label on the toner package.

TONER CARTRIDGE REPLACEMENT

When the toner cartridge replacement required (⋯) indicator lights up, replacement of the toner cartridge will be needed soon. Obtain a new cartridge. When the toner cartridge replacement required (⋯) indicator blinks, the toner cartridge must be replaced before copying can be resumed. Replace the toner cartridge by following the procedure below.



Note

During long copy run of a dark original, the start (⊞) indicator may blink, the indicator light up, and the unit stop, even though toner is left. The unit will feed toner up to 2 minutes and then the start (⊞) indicator will light up. Press the start (⊞) key to restart copying.

5

- 1** Open the multi-bypass tray, and then open the side cover while pressing the side cover open button.

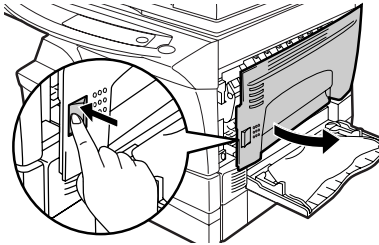

- 2** Push gently on both sides of the front cover to open the cover.

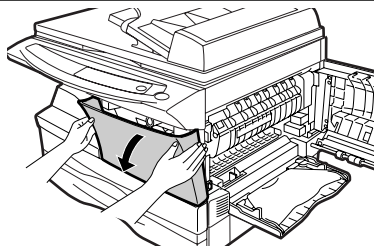

- 3 Gently pull the toner cartridge out while pressing the lock release lever.**

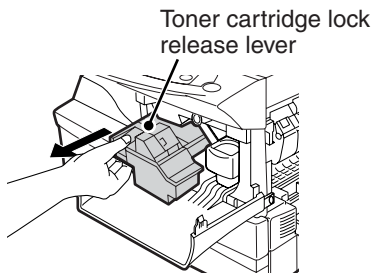

Note

- After removing the toner cartridge, do not shake it or tap on it. Doing so may cause toner to leak from the cartridge. Put the old cartridge immediately in the bag contained in the box of the new cartridge.
- Dispose of the old toner cartridge in accordance with local regulations.

- 4 Remove the toner cartridge from the bag. Grasp the cartridge on both sides and shake it horizontally four or five times. After shaking the cartridge, remove the toner seal.**

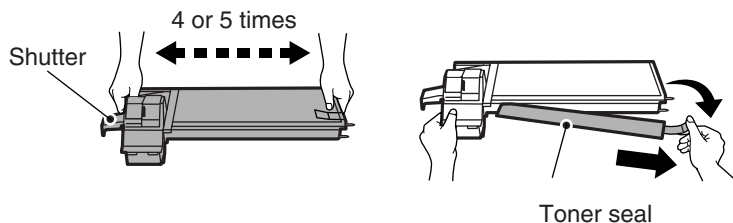

Note

Grasp the toner cartridge as shown in the illustration. Do not hold the cartridge by the shutter. Be sure to only shake the cartridge before the toner seal is removed.

- 5 Gently insert the toner cartridge along the guides until it locks in place while pushing the lock release lever. Remove the tape from the shutter. Pull the shutter out of the toner cartridge as shown in the illustration. Discard the shutter.**

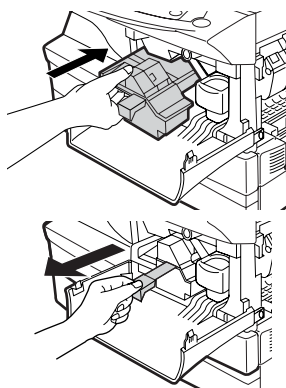

- 6** Close the front cover and then the side cover by pressing the round projections near the side cover open button. The indicator (⋯) will go out and the start (⊕) indicator will light up.



Caution

When closing the covers, be sure to close the front cover securely and then close the side cover. If the covers are closed in the wrong order, the covers may be damaged.

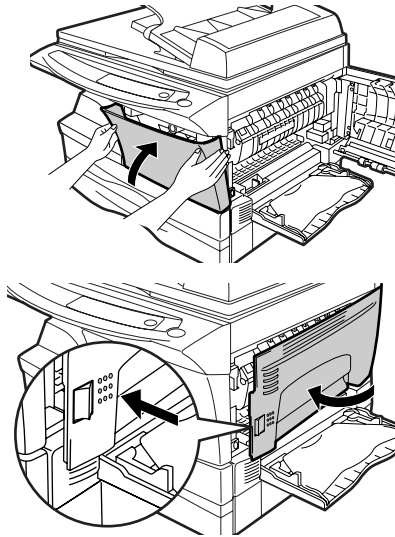

Note

Even after a new toner cartridge is installed, the start (⊕) indicator may not light up, indicating copying cannot be restarted (toner is not sufficiently fed). In this case, open and close the side cover. The copier will feed toner again approximately 2 minutes and then copying can be restarted.

5

Toner cartridge life

To find out the approximate quantity of toner remaining, follow the procedure below.

- 1** Press and hold down the light (⊖) and dark (⊕) keys simultaneously for more than 5 seconds until all the alarm indicators (⋯, ⚠, ⋯ and ⚠) blink and "E-" appears in the display.
- 2** Press and hold down the copy ratio display (%) key for more than 5 seconds.
The approximate quantity of toner remaining will be indicated in the display as a percentage. ("100", "75", "50", "25", or "10" is displayed.) When the percentage is less than 10%, "LD" will be displayed.
- 3** Press the light (⊖) or dark (⊕) key.
All the alarm indicators will go out.