

## 4

## SUPPLIES AND USER MAINTENANCE

This chapter describes how to replace the toner cartridge.



Caution

Be sure to use only genuine SHARP parts and supplies.

## TONER CARTRIDGE REPLACEMENT

When the toner cartridge replacement required (⋯) indicator lights up, replacement of the toner cartridge will be needed soon. Obtain a new cartridge. When the toner cartridge replacement required (⋯) indicator blinks, the toner cartridge must be replaced before copying can be resumed. Replace the toner cartridge by following the procedure below.



Note

During a long copy run of a dark original, the ready (⊙) indicator may blink, the ⋯ indicator light up, and the copier stop, even though toner is left. The copier will feed toner up to 2 minutes and then the ready (⊙) indicator will light up. Press the print (⊙) key to restart copying.

1

Ensure that the bypass tray is open and then open the side cover while pressing the side cover open button. Then, push gently on both sides of the front cover and open it.

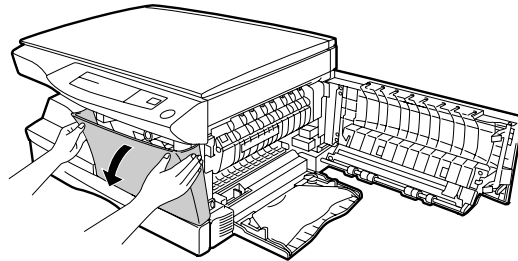
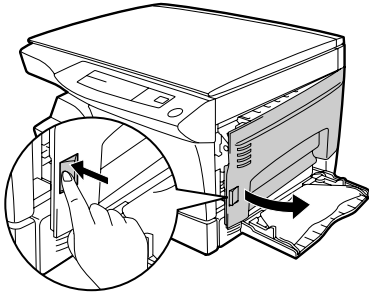

2

Push the toner cartridge lock release lever and pull the toner cartridge out. Dispose of the old toner cartridge in accordance with local regulations.

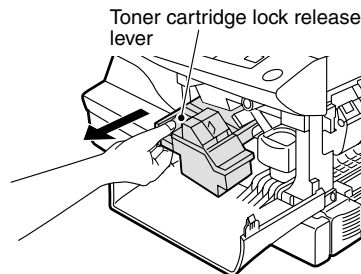

Note

After removing the toner cartridge, do not shake it or tap on it. Doing so may cause toner to leak from the cartridge. Put the old cartridge immediately in the bag contained in the box of the new cartridge.

4

Supplies and user maintenance



## TONER CARTRIDGE REPLACEMENT

- 3** Remove the toner cartridge from the bag. Grasp the cartridge on both sides and shake it horizontally four or five times. After shaking the cartridge, remove the toner seal.



Note

Grasp the toner cartridge as shown in the illustration. Do not hold the cartridge by the shutter. Be sure to only shake the cartridge before the toner seal is removed.

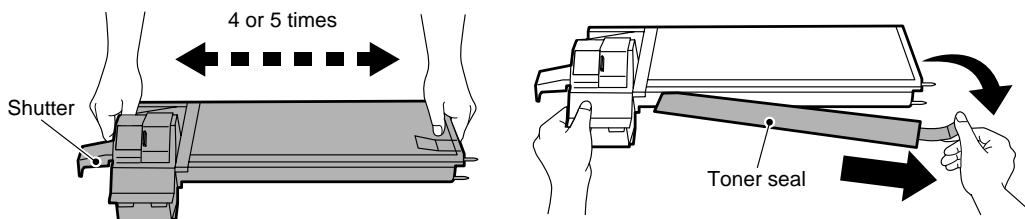

- 4** Gently insert the toner cartridge along the guides until it locks in place while pushing the lock release lever. Remove the tape from the shutter. Pull the shutter out of the toner cartridge as shown in the illustration. Discard the shutter.

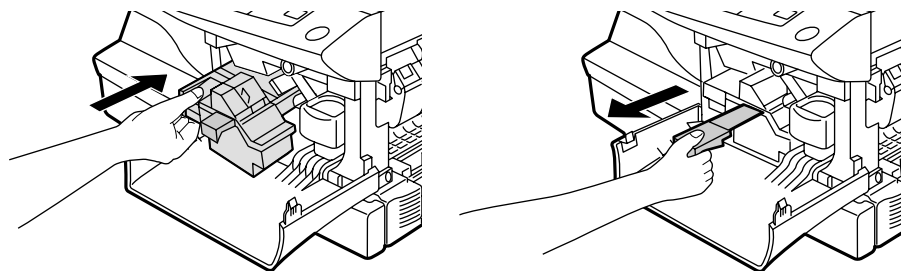

- 5** Close the front cover and then the side cover by pressing the round projections near the side cover open button. The  $\therefore$  indicator will go out and the ready (⊕) indicator will light up.



Caution

When closing the covers, be sure to close the front cover securely and then close the side cover. If the covers are closed in the wrong order, the covers may be damaged.



Note

Even after a new toner cartridge is installed, the ready (⊕) indicator may not light up, indicating copying cannot be restarted (toner is not sufficiently fed). In this case, open and close the side cover. The copier will feed toner again approximately 2 minutes and then copying can be restarted.

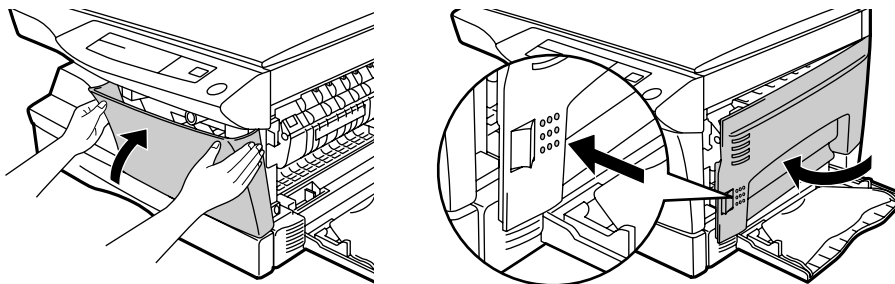

4

Supplies and user maintenance